

# Installation manual – Lim Tong Xin

## Space

The length and width of the space is approximately 6x3 meters. The clothes are arranged at a distance from each other as the audience should be able to walk under the clothes and view the drawings.

A custom frame (borne by artist) made of wood will be built in the space provided by MyTOWN shopping centre in which the clothes will be hung. An illustration is provided for a general idea. Details of this frame are yet to be confirmed with MyTOWN as the safety of shoppers must also be considered.

## Clothes arrangement

The materials used for hanging will stabilize the clothes (screw, Iron wire rope clip, thimbles and ferrules, wire rope, and transparent clothes hangers and with built a space -the shape is like house).

The clothes will be hung on the transparent clothes hanger. The hook on the hanger is to be removed, then tied up with the wire rope and clip. After tying, it will create a loop which will then be hung from hooks on the ceiling.



The picture illustrates my plan. For illustration purposes, the actual items will not be as large as in the sketch.

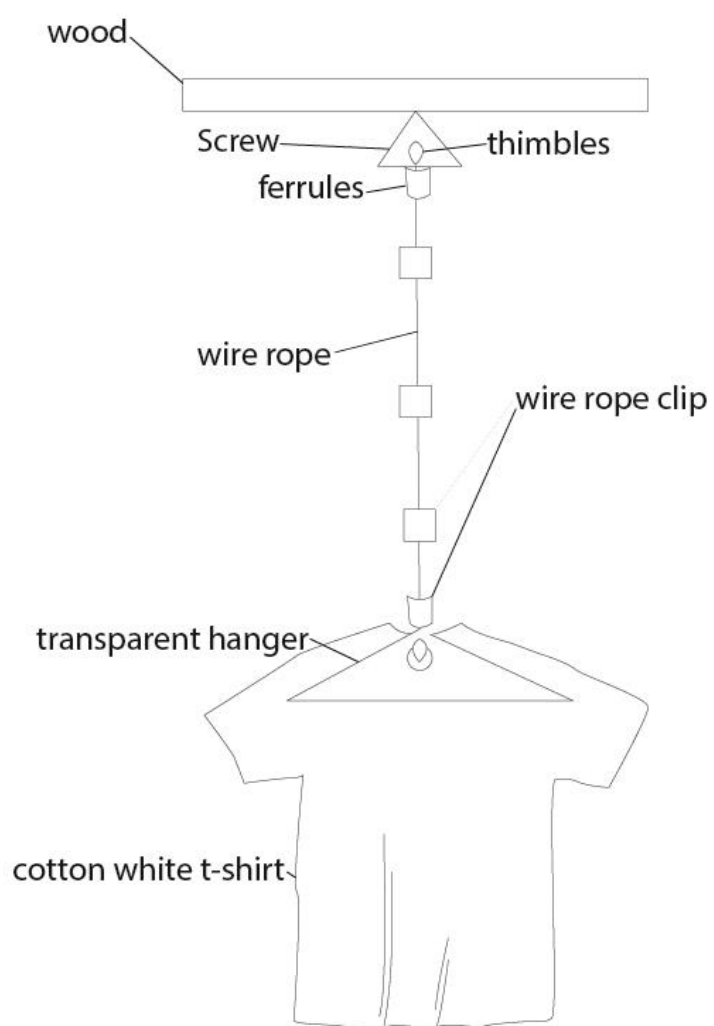
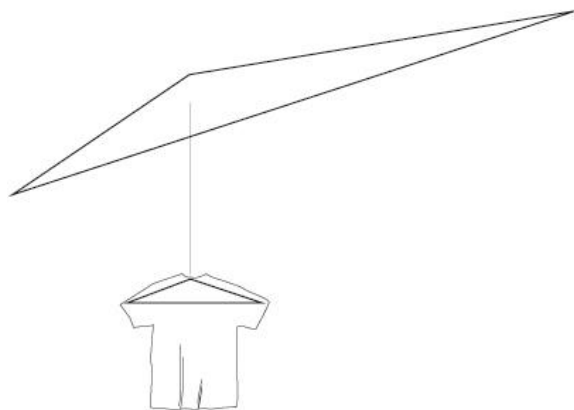

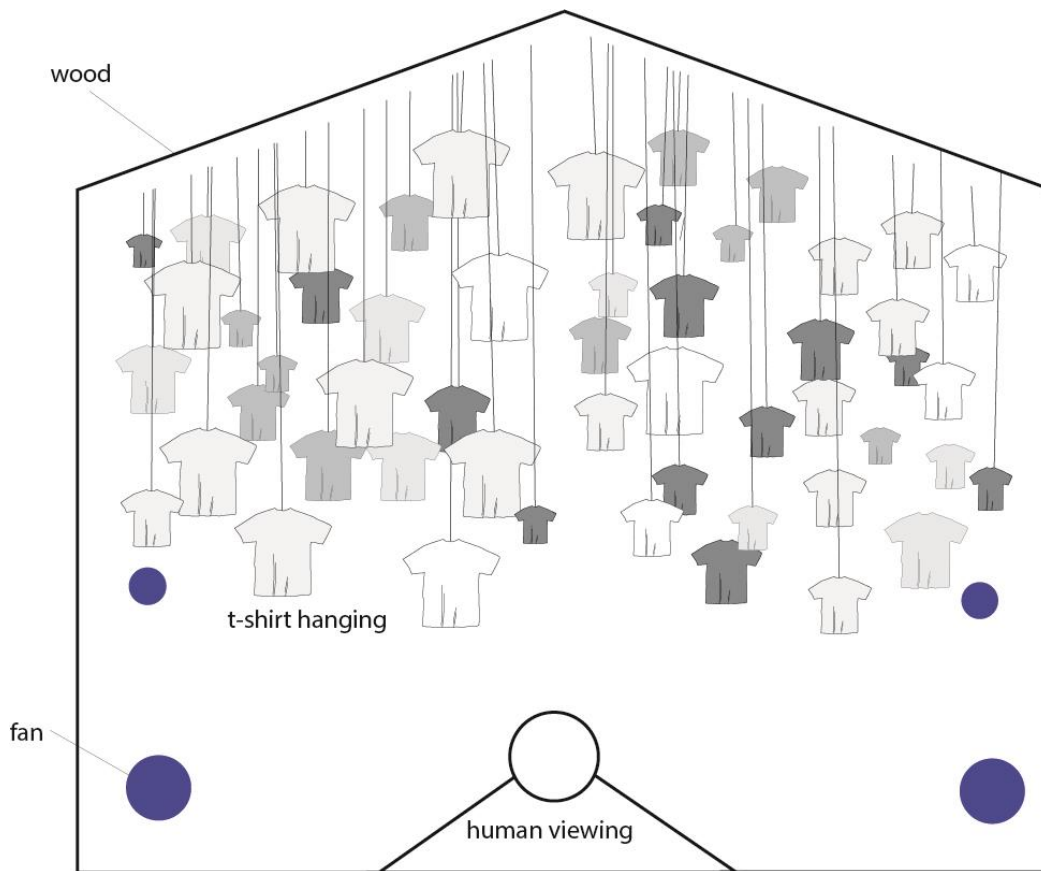

Venue- My town level 2

Front view

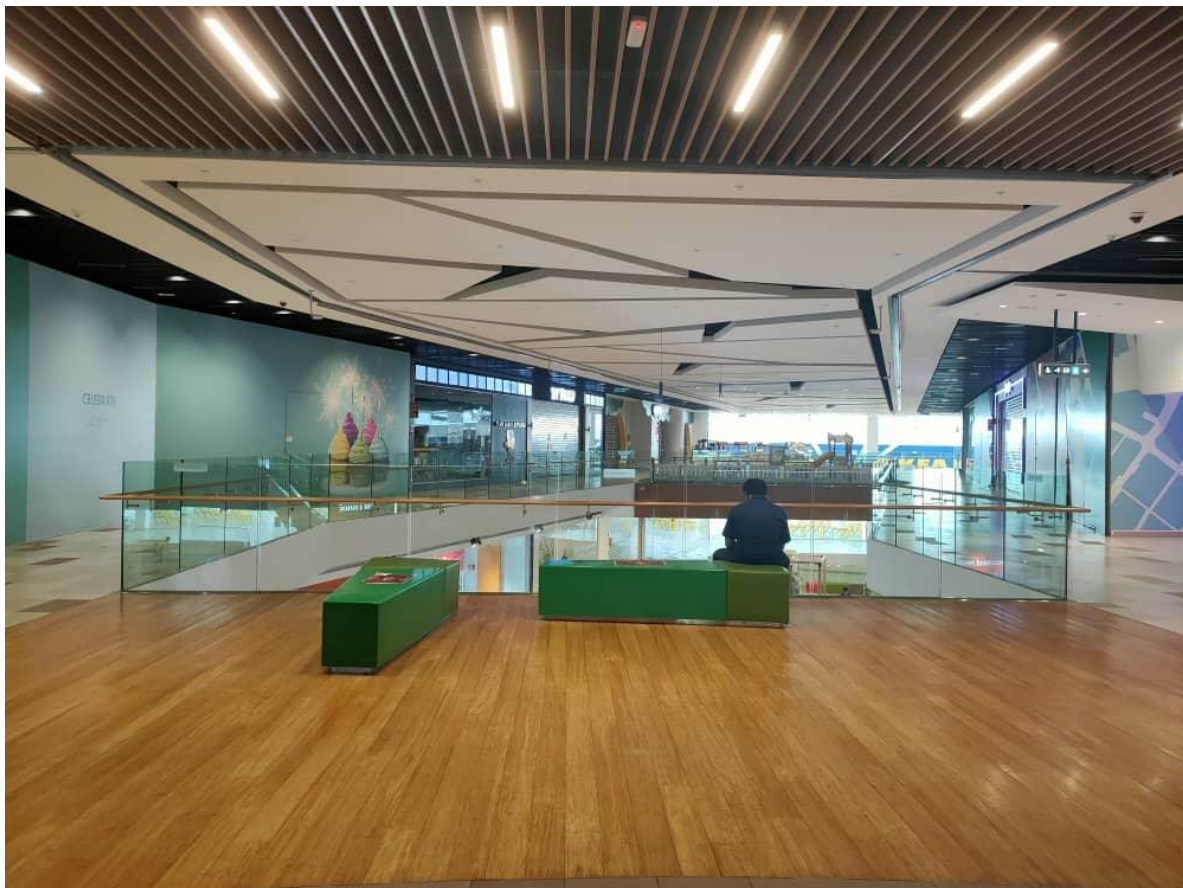

Side view







Art installed in the common area in front of escalator